

Tool Box - Multi Data Analysis

This function is similar to Sensor Data Diagnosis, which supports the analysis of each sensor item of multiple controllers mounted on the vehicle on a single screen at the same time.

* It only supports modules that support CAN communication protocol.

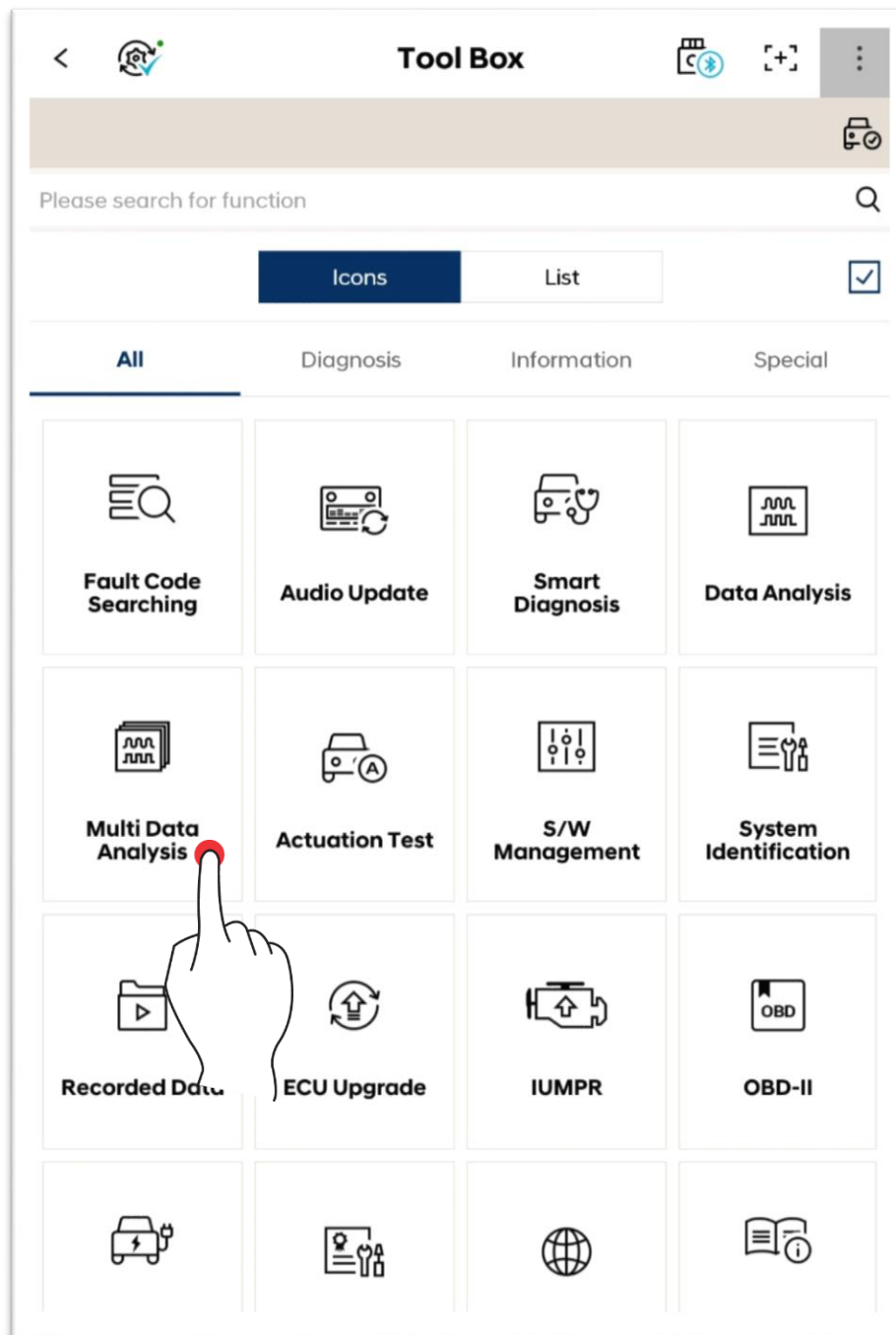

Sensor Data Item Selection

Select a sensor data item to analyze.

Select items for each system to analyze.

Multi Data Analysis

Setting Sensor Data

System

ENGINE (Engine Control) **AT** (Automatic Transaxle) **EPB** (Elec tric ...) **ESC** (Ele ctr ...) **EP** (Mot or dr)

Item Selection ☒ ☐

Please enter the search word

Battery Voltage
Battery Voltage after IG Key
Actual Engine Speed
Target Idle RPM
Mass Air Flow Sensor Value
Pressure Sensor(MAP) Signal Voltage
Intake Manifold Pressure
Water Temperature Voltage
Water Temperature
Ambient Air Temperature
Barometric Pressure Sensor Voltage

Selected Item

System	Sensor
--------	--------

Cancel OK

Select the entire items

Window for entering search word

Cancel all items

Spread/fold

Mode

This section describes the sensor data indicating mode.

Text Mode

It indicates sensor data in text format.

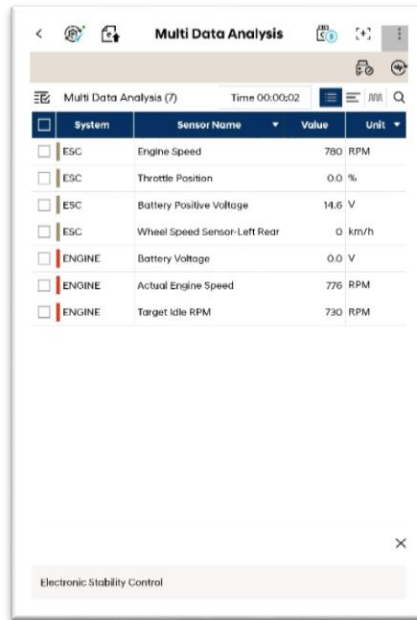

Multi Data Analysis (7) Time 00:00:02

<input type="checkbox"/>	System	Sensor Name	Value	Unit
<input type="checkbox"/>	ESC	Engine Speed	780	RPM
<input type="checkbox"/>	ESC	Throttle Position	0.0	%
<input type="checkbox"/>	ESC	Battery Positive Voltage	14.6	V
<input type="checkbox"/>	ESC	Wheel Speed Sensor-Left Rear	0	km/h
<input type="checkbox"/>	ENGINE	Battery Voltage	0.0	V
<input type="checkbox"/>	ENGINE	Actual Engine Speed	776	RPM
<input type="checkbox"/>	ENGINE	Target idle RPM	730	RPM

Electronic Stability Control

Bar Graph Mode

It indicates sensor data in bar graph format.

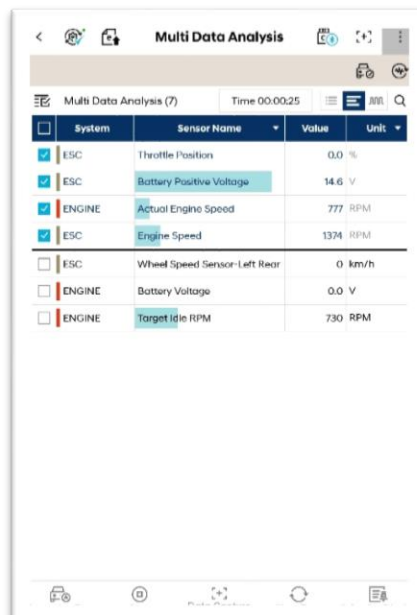

Multi Data Analysis (7) Time 00:00:25

<input type="checkbox"/>	System	Sensor Name	Value	Unit
<input checked="" type="checkbox"/>	ESC	Throttle Position	0.0	%
<input checked="" type="checkbox"/>	ESC	Battery Positive Voltage	14.6	V
<input checked="" type="checkbox"/>	ENGINE	Actual Engine Speed	777	RPM
<input checked="" type="checkbox"/>	ESC	Engine Speed	1374	RPM
<input type="checkbox"/>	ESC	Wheel Speed Sensor-Left Rear	0	km/h
<input type="checkbox"/>	ENGINE	Battery Voltage	0.0	V
<input type="checkbox"/>	ENGINE	Target idle RPM	730	RPM

Graph Mode

It indicates the selected sensor data in graph format.

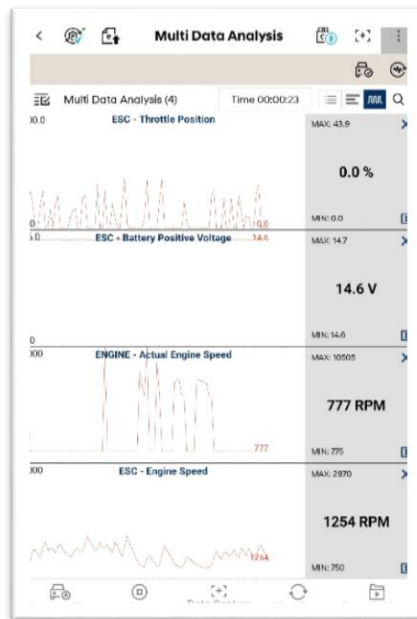

User Group

You can use the User Group function via  button on top left corner of screen.

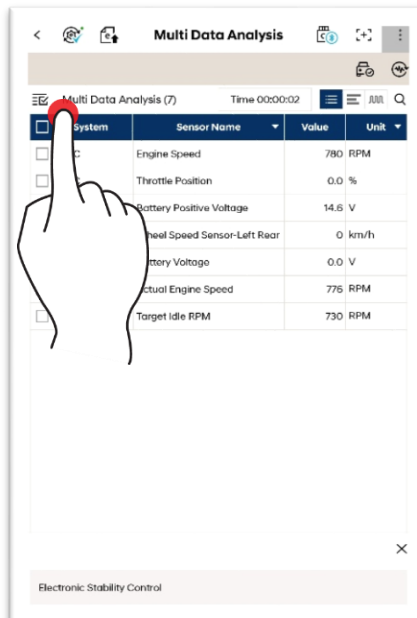

System	Sensor Name	Value	Unit
<input type="checkbox"/>	Engine Speed	780	RPM
<input type="checkbox"/>	Throttle Position	0.0	%
<input type="checkbox"/>	Battery Positive Voltage	14.6	V
<input type="checkbox"/>	Wheel Speed Sensor-Left Rear	0	km/h
<input type="checkbox"/>	Battery Voltage	0.0	V
<input type="checkbox"/>	Actual Engine Speed	776	RPM
<input type="checkbox"/>	Target Idle RPM	730	RPM

Electronic Stability Control

1. After entering User Group function, select sensor data items to be grouped.

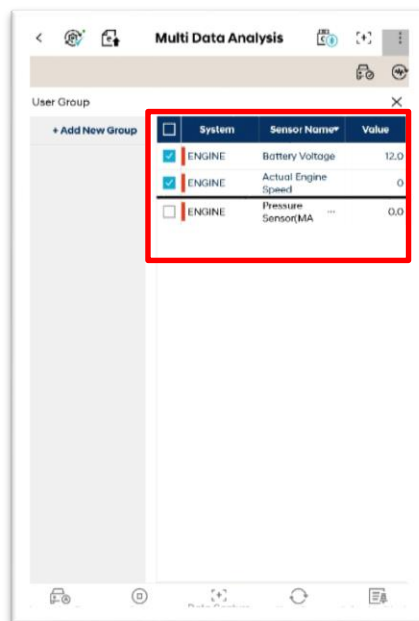

2. Once item selection is completed, create a group via 'Add a New Group'.

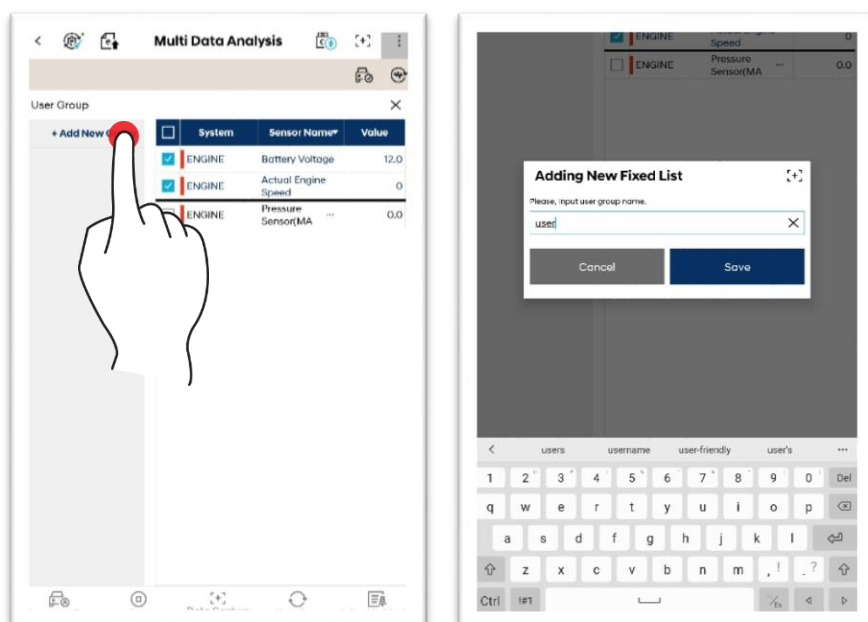

3. Group creation is completed.

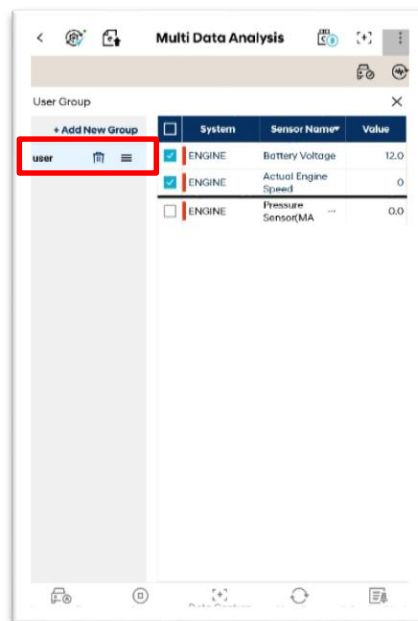

You can delete a created group.



You can change the group order.

Search

After entering a search word, touch , and you can search sensor data.

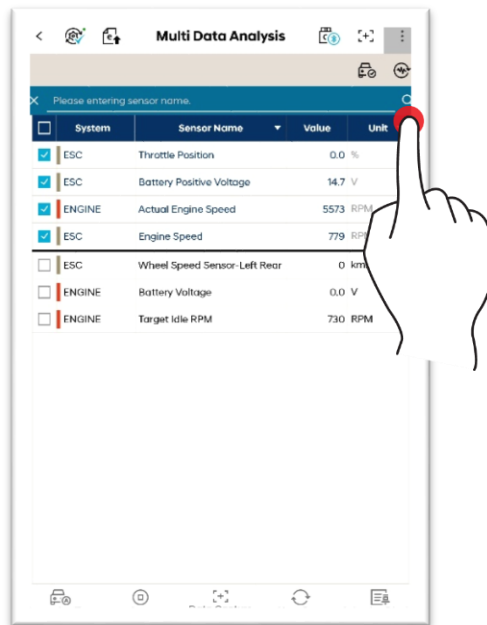



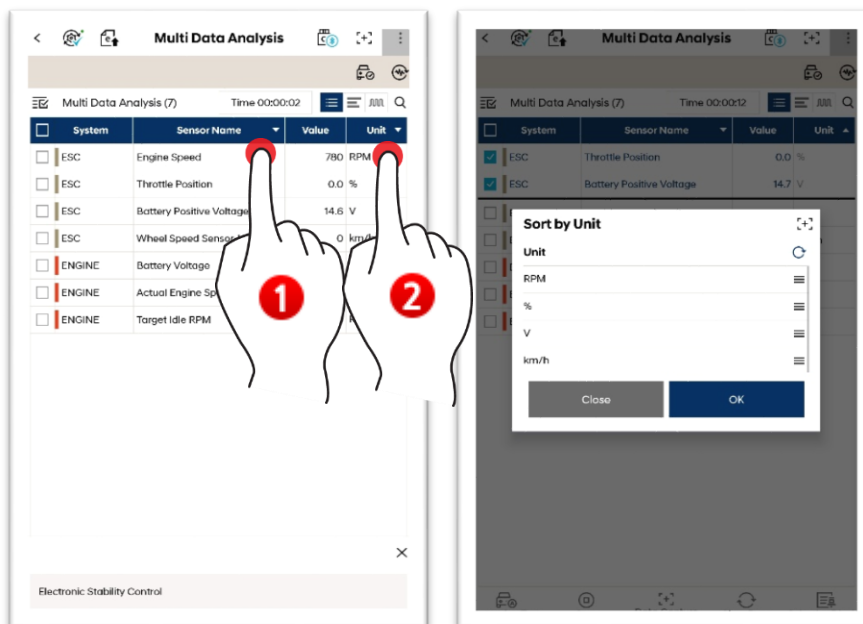

Arrangement, Unit Change

You can arrange items by touching sensor names, and change the unit by touching unit.

Touch  at top right corner of each title.



Bottom Function Buttons

 Selective Display	<p>This only shows the sensor values of the sensor data items, which were selected based on needs.</p> <p>The entire sensor data values are shown when Fixed Output function is turned off.</p>
 Actuation Test	<p>You can check change in sensor data by forcefully driving the actuator through Control Module.</p> <p>Select a system to perform forced driving.</p>
 Clear Data	<p>This initializes the collected sensor data values, and recollects them.</p>
 Stop	<p>This function collects sensor data values over a certain period of time, and stops the sensor data values. 'Start' and 'Stop' buttons operate in turn.</p>
 Recorded Data	<p>This function analyzes the saved sensor data file.</p> <p>This is linked to Saved Data Analysis function.</p>

Screen Control

1. You can spread or fold the screen by dragging  button upwards or downwards.

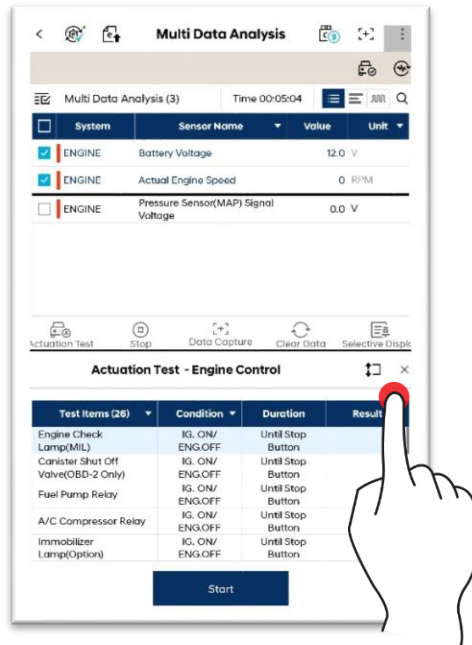

2. You can maximize/minimize the items in Graph Mode.

